



CRG COMPANIES, INC

INFO@CRGHOMES.COM // 843.651.8460

LIVINGDUNES.NET

LIVE LOCAL, LIVE SMART, LIVING DUNES



Floor plans and elevations are artist's renderings and may contain options which are not standard on all models. Living Dunes reserves the right to make changes to these floor plans, specifications, dimensions, and elevations without prior notice. Stated dimensions and square footage are approximate and should not be used as representation of the home's precise or actual size. [PLN4.0:V2]

LIVING DUNES

A GRANDE DUNES COMMUNITY

THE SOUTHPORT
PALMETTO COLLECTION

TOTAL HEATED SQFT: 1,924
- 1ST FLOOR: 1,924
TOTAL UNHEATED SQFT: 961
TOTAL SQFT: 2,885

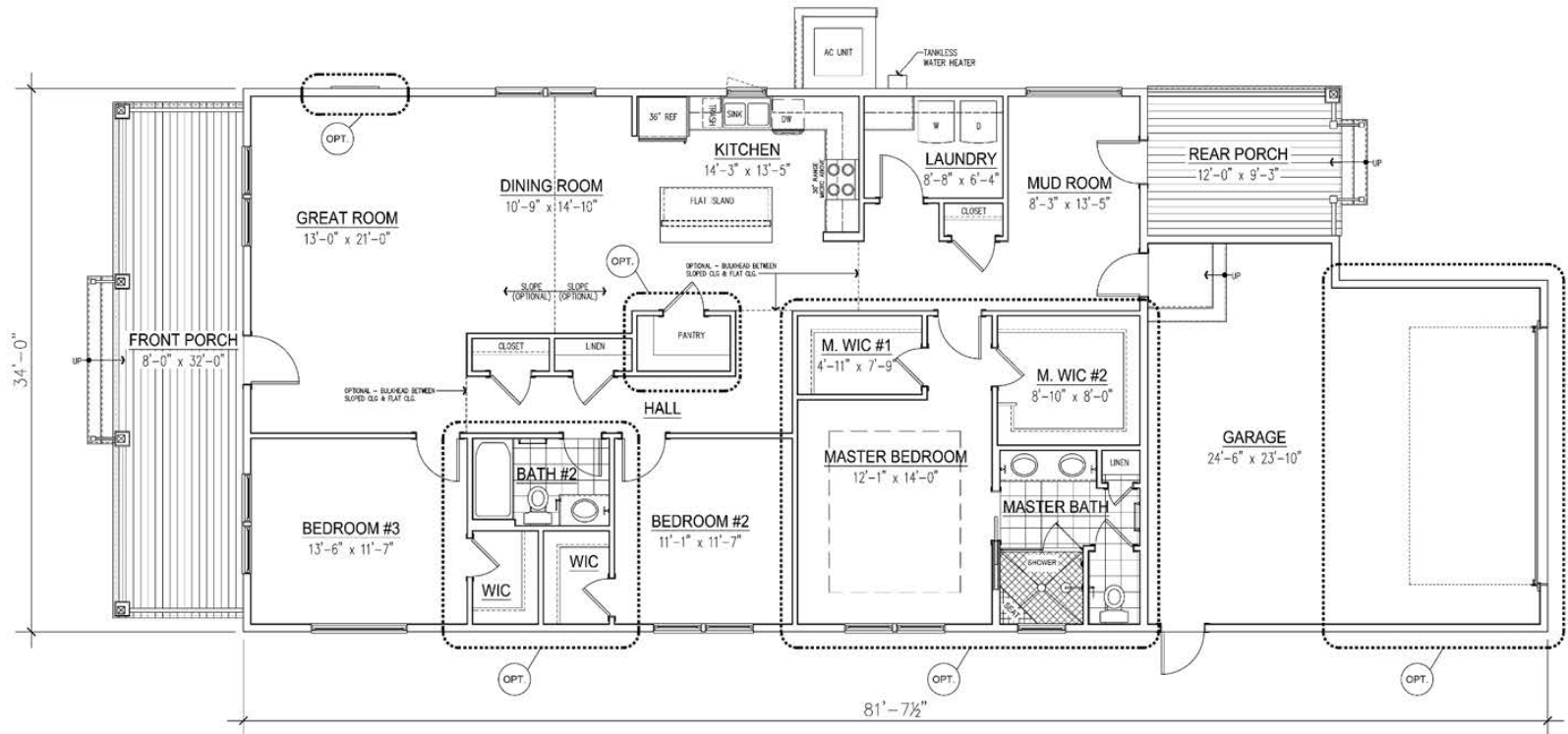

FIRST FLOOR

FOR SALES INFORMATION CONTACT CRG COMPANIES: 843-651-8460 | INFO@CRGHOMES.COM



Floor plans and elevations are artist's renderings and may contain options which are not standard on all models. Living Dunes reserves the right to make changes to these floor plans, specifications, dimensions, and elevations without prior notice. Stated dimensions and square footage are approximate and should not be used as representation of the home's precise or actual size. [PLN4.0:V2]